

HairMax LaserComb®

Advanced 7, Lux 9, Professional 12



USER MANUAL

TABLE OF CONTENTS

Introduction.....	1
Who is the best candidate? (Classifications male/female).....	2
Who is the best candidate? (Fitzpatrick Skin Types).....	3
Warnings and Cautions.....	4
Risks/Testing for sensitivity.....	5
How to Monitor Device Activity.....	6
Device Failure Mode.....	6
Expected Life of the HairMax LaserComb.....	6
Summary of Clinical Study in Men.....	7
Summary of Clinical Study in Women.....	8

HairMax LaserComb Advanced 7

HairMax LaserComb Advanced 7 Parts.....	9
Getting Started.....	10
Replacing the Batteries.....	10
Proper Use.....	11
Treatment Instructions.....	12
What your HairMax Advanced 7 comes with.....	13
Troubleshooting.....	14
Safety Label.....	15
Power Supply Specifications.....	15

HairMax LaserComb Lux 9, Professional 12

HairMax LaserComb Lux 9, Professional 12 Parts.....	16
Getting Started.....	17
Charging Options.....	17
Proper Use.....	18
Treatment Instructions.....	19
What your HairMax Lux 9 or Professional 12 comes with.....	21
Troubleshooting.....	22
Safety Label.....	23
Power Supply Specifications.....	23
Cleaning Your HairMax LaserComb	24
Electrical Safety.....	24
Disposal Instructions	25
Warranty.....	26
Warranty Card.....	27

HairMax Customer Service:

Phone: 1-866-527-3726
+1-561-417-0200
Email: info@hairmax.com
HAIRMAX.com

Mailing Address:

Lexington International
777 Yamato Rd., Ste 105
Boca Raton, FL 33431
USA

To view videos about usage, quality and safety, visit:

www.hairmax.com/videos

www.hairmax.com/QualitySafety

Introduction of HairMax LaserComb®

The HairMax LaserComb is a home-use laser device that has been Clinically Proven to treat heredity hair loss in men and women. The LaserComb is an over-the-counter (OTC) device that can be sold directly to the public.

Indications

The HairMax LaserComb Advanced 7, Lux9, and the Professional 12 models are indicated to treat Androgenetic Alopecia, and promote hair growth in females who have Ludwig (Savin) I-4, II-1, II-2, or frontal patterns of hair loss and in males who have Norwood Hamilton Classifications of IIa to V and who both have Fitzpatrick Skin Types I to IV.

How the LaserComb works

The LaserComb works by providing laser energy to stimulate hair follicles. For optimal results, the laser must not be blocked by the hair and must have an unobstructed path to the scalp. The LaserComb has teeth that

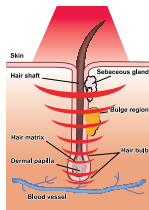

part the hair and allow the maximum amount of laser energy to reach the scalp.

Treatment with HairMax LaserComb

The LaserComb should be used 3 times per week, spaced out every other day. For example, Monday, Wednesday, Friday. The LaserComb should not be used more than the recommended treatment time per day. Recommended treatment; Advanced 7 = 15 minutes, Lux 9 = 11 minutes, Professional 12 = 8 minutes. Clinical studies demonstrate that most users see benefits in as little as 16 weeks.

HairMax LaserComb Benefits

A clinical study was conducted in men and women over a six month time period. The study showed that 90% of the men and women had an increase in the number of hairs (based on a minimum of 32 new hairs per square inch being observed at follow up).

See pages 7-8 for detailed results of the study.

WHO IS THE BEST CANDIDATE FOR HAIRMAX LASERCOMB?

How do you know if the HairMax LaserComb is right for you?

The LaserComb can be used by men and women with thinning hair (including color treated hair) or pattern baldness caused by a hereditary condition. Doctors use a system known as the **Norwood Hamilton Classification (men)** and the **Ludwig-Savin Classification (women)** to describe the degree of hair loss. Below are the pictures of the scales. The shaded areas show the type of hair loss that can be treated with the LaserComb.

Norwood Hamilton Classification - Males

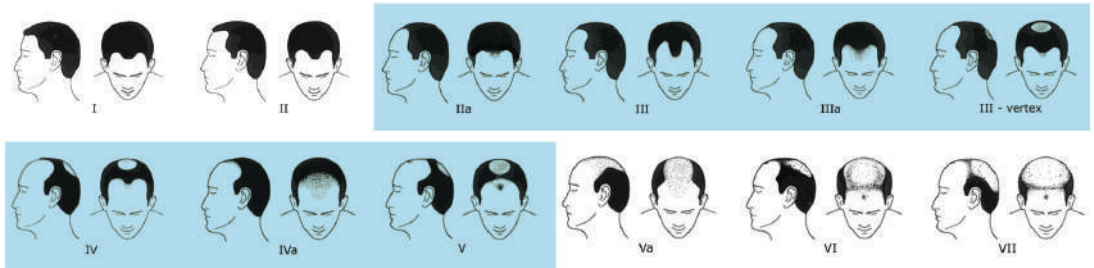

Ludwig-Savin Classification - Females

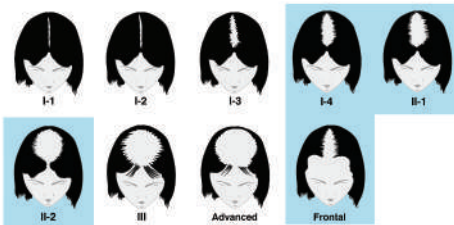

The HairMax LaserComb has not been clinically tested for hair loss outside of the shaded areas.

WHO IS THE BEST CANDIDATE FOR THE HAIRMAX LASERCOMB?

The LaserComb was only studied in light to brown skin tones (Types 1,2,3,4) as described in the Fitzpatrick Scale below. If your hair loss and skin tone fall into these categories, the LaserComb should work for you.

Fitzpatrick Skin Type Classification Guide: A way to describe your skin type based on your complexion and what happens to your skin in sunlight.

Type 1	Clinically Tested to be effective for these skin types	Very white or freckled skin, always burns with sun exposure (very fair; often in people with red or blond hair and blue eyes)
Type 2		White skin, usually burns with sun exposure (fair; often in people with red or blond hair and blue, green, or hazel eyes)
Type 3		White or olive skin tone, sometimes burns with sun exposure (fair; seen in people with any hair or eye color)
Type 4		Brown skin, rarely burns with sun exposure (common in people of Mediterranean descent)
Type 5	Not Clinically Tested for these skin types	Dark brown skin, very rarely burns with sun exposure (common in people of Middle-Eastern descent)
Type 6		Black skin, rarely burns with sun exposure

Adapted from Fitzpatrick's Dermatology in General Medicine. McGraw-Hill Professional; 5th edition.

Please note that HairMax was only tested on light to brown skin tones. This does not indicate that it will not work on darker skin tones.

WARNINGS AND CAUTIONS

WARNINGS

- ⚠ Do not stare directly at the red laser light or its reflection in a mirror because it can temporarily irritate your eyes. If you stare at the light for too long, it could harm your eyes. Also, never use a magnifying glass when using the LaserComb because it can cause temporary irritation to your eyes.
- ⚠ Keep the LaserComb out of the reach of children.
- ⚠ Do not drop the LaserComb in water because you may get an electrical shock. If the LaserComb gets damaged by water, contact Customer Service toll-free at 1-866-527-3726.
- ⚠ If the cord is damaged on the LaserComb do not use the device because you could get an electrical shock. If the cord gets damaged, contact Customer Service toll-free at 1-866-527-3726.
- ⚠ Do not use the LaserComb near any heated surfaces because this could cause the device not to work properly and may cause an electrical shock. Contact Customer Service toll-free at 1-866-527-3726.
- ⚠ Laser light - avoid direct eye exposure.

CAUTIONS

- ⚠ If you are taking any medications or products that make you sensitive to light, you should test the LaserComb to make sure you do not have a reaction. Some of the things that can cause increased sensitivity to the LaserComb could be medicines for colds, allergies, pain medicine and drugs to treat infections. **To test the LaserComb for sensitivity**, turn the device on, hold the device on one spot, shining the light on your forearm. After two minutes, turn the device off and set aside. Look at the spot where you held the laser light over the next five minutes. If you see any reaction such as redness or rash, do not use the LaserComb and contact our Customer Service toll-free at 1-866-527-3726 to return your product and get a refund.
- ⚠ Only use the LaserComb as directed. Do not try to change the way the LaserComb operates. Changes may result in harmful laser exposure. Contact Customer Service toll-free at 1-866-527-3726 for repairs.
- ⚠ Never use acetone or other solvents on any part of the LaserComb. Use of solvents on the window can block the laser light from coming through.

NOTICE: If any malfunction occurs, do not attempt to repair the LaserComb yourself. This appliance has no user-serviceable parts. Use the LaserComb only for its intended use as described in this manual. Contact Customer Service toll-free at 1-866-527-3726.

Risks

HairMax LaserComb has been clinically tested on both men and women. In the clinical study for men, 5% of the men said they had itching or tingling from using the LaserComb. None of the women in the clinical study reported any of these side effects from using the LaserComb. If you have itching, tingling or any other side effect that bothers you, stop using the LaserComb and contact Lexington's Customer Service toll-free at 1-866-527-3726.

Testing the LaserComb for sensitivity

Before beginning treatment, be sure to test the HairMax LaserComb for sensitivity. Turn the device on, hold the LaserComb on one spot, shining the light on your forearm. After two minutes, turn the device off and set aside. Look at the spot where you held the laser light over the next five minutes. If you see any reaction such as redness or rash, do not use the HairMax LaserComb and contact Customer Service toll-free at 1-866-527-3726 to return your product and get a refund. If you don't experience any reaction, proceed with the treatment instructions on page 12 for Advanced 7 or page 19 for Lux 9 and Professional 12 models.

How to Monitor Device Activity

Your HairMax LaserComb is inspected and tested during production. When working properly, both of the green and the red light indicators on the power and laser buttons turn on. A red laser light shines through the window at the bottom of the device. Do NOT look directly at the laser light. Shine the laser light onto the palm of your hand to see if the red laser light appears.

If one or both of the light indicators is not lit, or if the laser light does not appear, contact Customer Service toll-free at 1-866-527-3726 for repair or replacement.

Device Failure Mode

The HairMax LaserComb is designed to last for 10-15 years of continuous use. The laser light does not fade or diminish over time. At the end of the laser's life or if it fails for any other reason, the red laser light will no longer shine out of the device.

Expected Life of the HairMax LaserComb

The HairMax LaserComb is a medical device manufactured under strict quality controls and validated through GMP (Good Manufacturing Practices). The HairMax LaserComb contains high quality laser diodes designed to last at least 15,000 hours. Based on that rating and the durability of the components being used, the expected life of the LaserComb is 10-15 years of regular use. Please take time to read this entire instruction manual before operating the HairMax LaserComb.

SUMMARY OF CLINICAL STUDY IN MEN

Clinical studies were conducted at multiple locations in the United States. Participants in the study were males diagnosed with Androgenetic Alopecia, which includes hereditary hair loss, and had light to medium skin tones. Subjects were divided into two groups, LaserComb Group and a Control Group. The Control Device looked and sounded like the LaserComb device but did not include a laser light. The Clinical studies adhered to all GCP (Good Clinical Practice) guidelines, were approved by an IRB (Institutional Review Board) and listed on www.clinicaltrials.gov.

During the 6 month clinical study, subjects treated their hair once per day, 3 times per week on non-consecutive days. The number of thick, normal healthy hairs in the target zone were counted at week 1, week 16 and week 26.

Results at the 26 week visit showed that over 90% of the men saw an increase in hair counts (based on a minimum of 32 new hairs per square inch being observed at the follow up visit).

No subjects in the study experienced any serious adverse events. In fact, the number and types of adverse events were similar in the LaserComb and Control Groups.

Hair Count Change

In the clinical study, after 26 weeks of treatment with the LaserComb devices versus the Control Device, the following increases in hair count were found.



Mean Terminal Hair Count Changes
From Baseline in MALES
26 Weeks

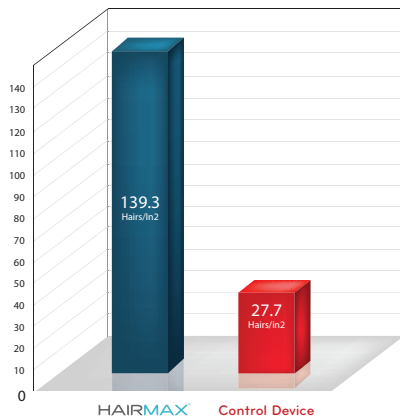

SUMMARY OF CLINICAL STUDY IN WOMEN

A clinical study was conducted at multiple locations in the United States. All participants in the study were females, diagnosed with Androgenetic Alopecia, which includes hereditary hair loss, and had light to medium skin tones. Subjects were divided into two groups. One group used the LaserComb and the other group used a Control Device. The Control Device looked and sounded like the LaserComb, but did not include a laser light. The Clinical studies adhered to all GCP (Good Clinical Practice) guidelines, were approved by an IRB (Institutional Review Board) and listed on www.clinicaltrials.gov.

During the 6 month study, subjects treated their hair once per day, 3 times per week, on non-consecutive days. The number of thick, normal, healthy hairs in the target area were counted at Week 1, Week 16 and Week 26.

Results at 26 weeks showed that over 90% of the women saw increases in hair counts (based on a minimum of 32 new hairs per square inch being observed at the follow up visit).

No subjects in the study experienced any serious adverse events. In fact, the number and types of adverse events were similar in the HairMax LaserComb and control groups.

Hair Count Change

In the clinical study, after 26 weeks of treatment with the LaserComb and a Control Device, the following increases in hair count were found.



Mean Terminal Hair Count Changes
From Baseline in FEMALES
26 Weeks

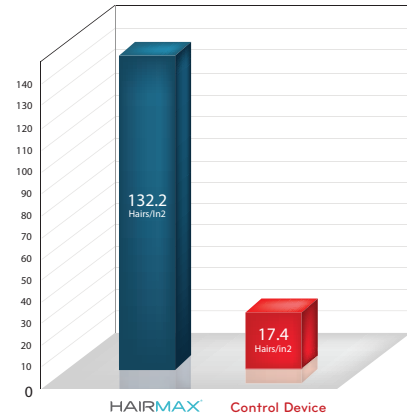

HAIRMAX LASERCOMB ADVANCED 7

- A POWER/LASER BUTTON
- B BATTERY INDICATOR
- C POWER CORD optional, not included
- D SAFETY LABEL
- E TEETH
- F BATTERY COVER TAB
- G LASER WINDOW
- H WARNING LABEL
- I CRADLE/STAND



! THIS SECTION APPLIES TO ADVANCED 7 MODEL ONLY

For Lux 9 and Professional 12 Models refer to pages 16-23 for instructions

Your **LaserComb Advanced 7** comes with four AA batteries already installed. To use the LaserComb Advanced 7 you must remove the cardboard protective strip located in the battery compartment. Follow these steps:

1. **Verify the model of your device located on the handle.** If you purchased a Lux 9 or Professional 12 models, refer to pages 16-23 of this User Manual.
2. Remove the blue label on this bottom of the LaserComb.
3. Using a thin coin or your finger nail, depress the Battery Cover Tab (see Figure A) and remove battery door.
4. Open the battery compartment.

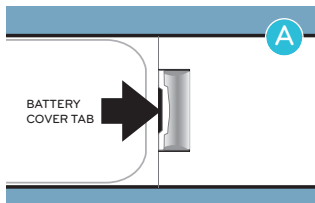

5. Locate, remove and discard the cardboard protective strip (Figure B).
6. Replace Battery Cover by aligning bottom of Cover in grooves and then pressing the top of Cover until it snaps into place.
7. Your LaserComb is now ready for use.

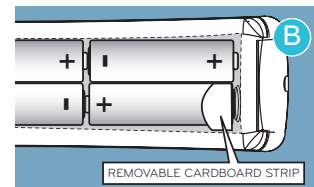

Replacing Batteries

The LaserComb is designed to provide the optimum laser output even as the batteries age. When the batteries weaken to the point where they will no longer power the lasers to their optimum power level, the green battery indicator will flash from green to red and the lasers will shut off.

This is an indication that the batteries need to be replaced. Use the following steps to replace the batteries.

Replacing Batteries - continued

1. Using a thin coin or your finger nail, depress the Battery Cover Tab (see Figure A) and remove battery door.

2. Insert 4 AA batteries. Be sure to align batteries as shown on bottom of battery compartment (Figure C).

3. Replace Battery Cover by aligning bottom of Cover in grooves and then pressing the top of Cover until it snaps into place.

In addition, the LaserComb can be powered directly by the optional power cord. Plug the power cord into the end of the LaserComb. Plug the other end into an electrical wall outlet (Figure D). Do not use the Laser-Comb if the device is damaged or defective, instead call Customer Service toll-free at 1-866-527-3726.

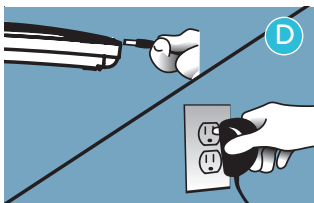
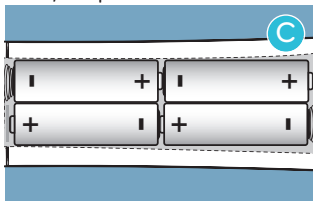

Proper Use

Read and follow all directions prior to use. If you are using the power cord (optional-not included), place one end directly into the handle end of the LaserComb and the other end into an electrical wall outlet

(Figure D). **Use the LaserComb for 15 minutes per treatment, three treatments per week.**

The treatments should be spaced every other day, for example Monday, Wednesday, Friday. Do not use the LaserComb more than 15 minutes per treatment day. Most users see benefits in as little as 16 weeks (based on clinical studies).



Slide the power/laser button to the middle or top position (Figure E). **Middle position** activates the laser and vibrate feature. **Top position** is laser only. Shine the LaserComb onto the palm of your hand. You will see that the laser light is on. (Do not look at the laser light directly.) The LaserComb is now ready for use.

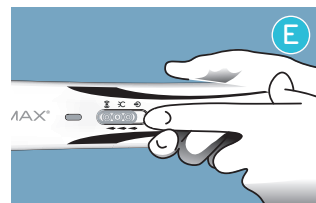

Treatment Instructions

Before beginning treatment, be sure to test the HairMax LaserComb for sensitivity (Page 5).

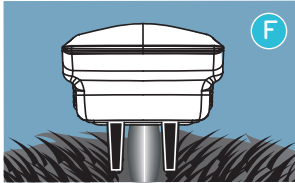

After you have turned on the LaserComb, place it flat on your scalp so that both rows of teeth are touching your scalp (Figure F).

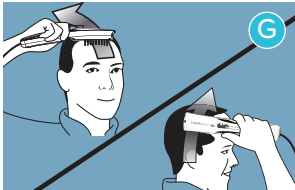

Start at your hairline. Move the LaserComb from front to back of scalp in a slow combing motion, stopping every ½ inch (1cm) and pausing for 4 seconds (Figure G). Do not lift the

LaserComb off your scalp while combing from front to back. Next, lift the LaserComb off your scalp and start at a new position at the hair line. Continue in this manner from front to back and then side to side until you cover your entire scalp with multiple passes.

IMPORTANT: Do not lift the LaserComb off your scalp while combing from front to back or side to side unless you are starting at the new position at the hairline. The LaserComb features a pair of comb teeth that part the hair so the light can more effectively penetrate to the scalp. You will make a few complete passes over your scalp within recommended treatment time.

Repeat these passes within the required treatment of 15 minutes. If you have long hair, use your fingers to lift your hair out of the way allowing the LaserComb to deliver the laser light to the scalp (Figure H).



Turn off the LaserComb by sliding the power/laser button to the lowest position (Figure I). If using the optional power cord, remove the power cord from electrical wall outlet. Store the device in the cradle/stand for future use.

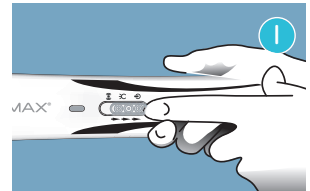

TREATMENT INSTRUCTIONS | WHAT IS INCLUDED - ADVANCED 7 MODEL



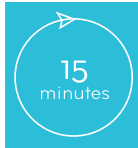



The LaserComb is most effective when used correctly. In order to help time the movements, the LaserComb will automatically vibrate every 4 seconds. **The vibration can be turned off** by sliding the power/laser button to the uppermost top position. The LaserComb should be used for 15 minutes. Use a watch or clock to time your treatment.



Please Note:

- It is important to move the LaserComb very slowly. Remember, you are bathing the scalp with laser light. If you move it too fast, the treatment will not achieve the optimal results to promote hair growth.
- Total time required for treatment with the Advanced 7 LaserComb is 15 minutes.

What is included:

					
Advanced 7 Model	Retail Box	4 AA batteries	Cradle/Stand	User Manual	Quick Start Guide

TROUBLESHOOTING - ADVANCED 7 MODEL

ANY ATTEMPT TO SELF-SERVICE YOUR DEVICE, UNLESS INSTRUCTED BY HAIRMAX CUSTOMER SERVICE, WILL VOID YOUR WARRANTY.

Troubleshooting

The LaserComb has advanced electronics to ensure that the device is working like it is supposed to and that the proper amount of laser energy is being delivered. If for some reason you are experiencing difficulties with your device, please try one of the tips below:

Your LaserComb will not turn on

- Make sure your LaserComb has fresh batteries or it is plugged into an electrical wall outlet.
- Insert optional power cord into the LaserComb. Slide the power/laser button to the on position.
- Try another electrical wall outlet.

Your LaserComb is turning off during use

- Make sure your LaserComb has fresh batteries or it is plugged into an electrical wall outlet.
- Insert optional power cord into the LaserComb. Slide the power/laser button to the on position.
- Try another electrical wall outlet.

Your LaserComb will not turn off

- Slide the power switch to the lowest OFF position.
- If using optional power cord, unplug the LaserComb.

Your LaserComb vibrates irregularly/doesn't vibrate

- Make sure the Power Switch is in the middle position.

Your LaserComb vibrates, but you do not see the laser

- Make sure your LaserComb has fresh batteries or plugged into an electrical wall outlet.

You have trouble understanding any of these instructions

- Contact Customer Service toll-free at 1-866-527-3726.

SAFETY LABEL LASER PARAMETERS	
Wavelength:	655nm +/- 10nm visible red light
Laser Power for classification	<5mW CW
Divergence	57 mrad
Number of lasers	7
This Laser Product is designated as Class 3R during all procedures of operation.	
Note:	LaserComb Advanced 7 has no user-serviceable parts.
Location:	On the underside of the handle Model version varies

Power Supply Specifications

Output = 6VDC 1.0A. Plug: 9mm x 3.5mm, center positive.

The optional power supply for the HairMax LaserComb can be used in the United States and Internationally. This power supply will adapt to all power supplies from 110 volt/60 cycle (US) to 240 volt/50 cycle. If outlets in your country have different plugs than the optional power supply, use an inexpensive plug adapter (not supplied with the device).



HAIRMAX LASERCOMB LUX 9, PROFESSIONAL 12

LaserComb Lux 9 and Professional 12 are identical models that vary only in the number of diodes and treatment time.

- A POWER BUTTON
- B LASER BUTTON
- C INFORMATION DISPLAY
- D POWER CORD
- E SAFETY LABEL
- F TEETH
- G LASER WINDOW
- H WARNING LABEL
- I CHARGING CRADLE/STAND



! THIS SECTION APPLIES TO LUX 9 AND PROFESSIONAL 12 MODELS ONLY

For Advanced 7 Model refer to pages 9-15 for instructions

Your **LaserComb Lux 9** and **Professional 12** come with a rechargeable battery already installed. Read this manual completely before you start to use your LaserComb.



Use the **LaserComb Lux9** for **11 minutes per treatment**, and **LaserComb Professional 12** for **8 minutes per treatment**, three treatments per week. The treatments should be spaced every other day, for

example Monday, Wednesday, Friday. Do not use the LaserComb more than the recommended treatment time per day. Most users see benefits in as little as 16 weeks (based on clinical studies).

When you receive the LaserComb take all the parts out of the case. Remove the red safety label. The power button and the laser button are located under the red safety label. You must charge your LaserComb for 2-3 hours before initial use.

Charging Options

Charging can be accomplished in one of the two following options:

OPTION 1: Charging the LaserComb using the charging cradle (stand) and power cord. Prior to placing the LaserComb in the cradle,

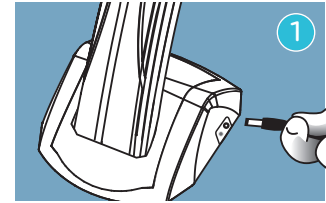

make sure your LaserComb is turned off and the teeth face away from you. Plug the power cord into the cradle and the other end into an electrical wall outlet. A green light will illuminate on the side of the charging stand indicating that your power cord is operating properly. During charging, the display on the LaserComb will illuminate for 20 seconds and the battery indicator bars will light up indicating the battery level and confirm the charging process. After 20 seconds the display will turn off but the battery will continue to charge.

OPTION 2: Charging the LaserComb by placing the power cord directly into the handle end of the Laser-Comb and the other end into an electrical wall outlet.

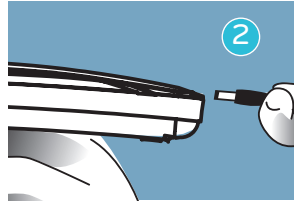

During charging, the display on the LaserComb will illuminate for 20 seconds and the battery indicator bars will light up indicating the battery level and confirm the charging process. After 20 seconds the display will turn off but the battery will continue to charge.

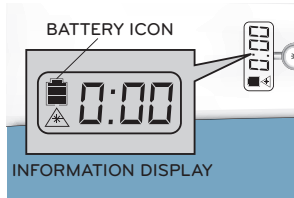

When the LaserComb requires charging, the battery icon on the information display will show low battery level. Charge your LaserComb with one of the charging options as described on page 17.

Proper Use

The LaserComb Lux9 should be used for 11 minutes and LaserComb Professional 12 for 8 minutes. Use a watch or clock to time your treatment.

First, press the power button and hold until power button light turns green. Second, press the laser button which will light up red. That means the LaserComb is ready for use.

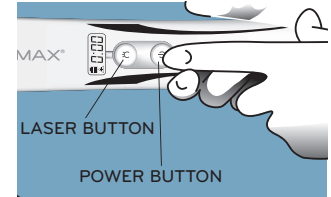

Shine the LaserComb onto the palm of your hand and you will see that the laser light is on (do not look at the laser light directly). Do not use the LaserComb if the device is damaged or defective, instead call Customer Service toll-free at 1-866-527-3726.

Please Note:

If your device needs to be recharged during your treatment, simply insert the power cord directly into the end of the device and other end into an electrical wall outlet and continue with your treatment. When finished, allow the device to fully charge.

The information display on the top of the LaserComb will show you 3 pieces of information:

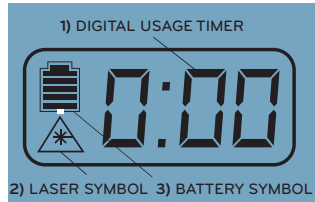

1. **Digital Usage Timer**
2. **Laser Symbol**
3. **Battery Symbol**

1. Digital Usage Timer - Indicates how long you have been treating your scalp. The LaserComb will automatically turn off after 15 minutes.

2. Laser Symbol - Indicates the laser is turned on.

3. Battery Symbol - Indicates the battery level. The indicator bars will flash while charging.

Treatment Instructions

Before beginning treatment, be sure to test the HairMax LaserComb for sensitivity (Page 5).

After you have turned on the LaserComb, place it flat on your scalp so that both rows of the teeth are touching your scalp (Figure A).

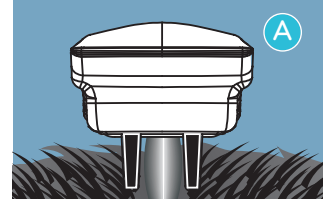

Start at your hairline. Move the LaserComb from front to back of scalp in a slow combing motion, pausing every ½ inch (1cm) for 4 seconds (Figure B). Do not lift the LaserComb off your scalp while combing from front to back.

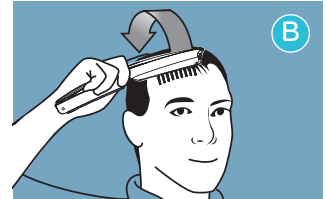

TREATMENT INSTRUCTIONS - LUX 9, PROFESSIONAL 12 MODELS

Next, lift the LaserComb off your scalp and start at a new position at the hair line. Continue in this manner from front to back and then side to side until you cover your entire scalp with multiple passes (Figure C).



Repeat these passes for the total treatment of 8 minutes for Professional 12 and 11 minutes for Lux 9 models. When the LaserComb is on it will beep and vibrate every four (4)

seconds. If you have long hair, use your fingers to lift your hair out of the way while using the LaserComb to be sure that the laser energy reaches your scalp (Figure D).



IMPORTANT: Do not lift the LaserComb off your head when moving every 4 seconds (unless you are checking the usage timer on the information display or until you complete the pass). The LaserComb features a pair of comb teeth that part the hair so the light can more effectively reach the scalp.

When the LaserComb is on it will beep and vibrate every four (4) seconds. This means that it's time to move the LaserComb to the next area of the scalp. When you do this, do not lift the device off of your scalp.

If you wish to **turn off the beep/vibration** during the treatment press the top laser button once (Figure E). Your LaserComb and laser will remain on. To re-activate beep and vibration, simply press the laser button twice.

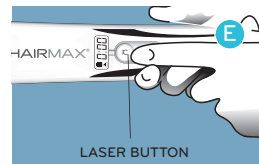

Turn off the LaserComb by pressing and holding the power button (lower button) until green indicator light turns off (Figure F). Store the device in the charging cradle for future use. You may leave the power cord plugged into the charging cradle at all times.

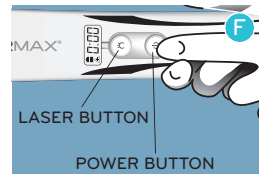

Please Note:

- It is important to move the LaserComb very slowly.
Remember, you are bathing the scalp with laser light. If you move it too fast, the treatment will not achieve the optimal results to promote hair growth.
- Total time required for treatment with the **LaserComb Lux9 is 11 minutes** and **LaserComb Professional 12 is 8 minutes**.

What is included:

 1	 2	 3	 4	 5	 6
Lux 9 Model or Professional 12	Retail Box	Charging Cradle	Universal Adaptor	User Manual	Quick Start Guide

TROUBLESHOOTING - LUX 9, PROFESSIONAL 12 MODELS

ANY ATTEMPT TO SELF-SERVICE YOUR DEVICE, UNLESS INSTRUCTED BY HAIRMAX CUSTOMER SERVICE, WILL VOID YOUR WARRANTY.

The LaserComb has advanced electronics to ensure that the device is working like it is supposed to and that the proper amount of laser energy is being delivered. If for some reason you are experiencing difficulties with your device, please try one of the tips below:

Your LaserComb will not turn on

- Make sure your LaserComb is fully charged.
- Insert the power cord into the LaserComb, then press the power button for 4 seconds and then the laser button.
- Try another electrical wall outlet.

If your LaserComb is turning off during use

- Make sure your LaserComb is fully charged.
- Insert the power cord into the LaserComb then press the power button for 4 seconds and then the laser button.
- Try another electrical wall outlet.

If your LaserComb will not turn off

- Press and hold power button for 4 seconds
- If using power cord, unplug the LaserComb and press power button for 4 seconds

If your LaserComb beeps/vibrates irregularly or doesn't beep/vibrate

- If using power cord, unplug the LaserComb. Plug in power cord again and press the power button then the laser button.

If your LaserComb beeps and vibrates, but you do not see the laser light

- If using power cord, unplug LaserComb. Plug in power cord again and press the power button then the laser button.
- If you have trouble understanding any of these instructions Contact Customer Service toll-free at 1-866-527-3726.

SAFETY LABEL | LASER PARAMETERS

Wavelength:	655nm +/- 10nm visible red light
Laser Power for classification	<5mW CW
Divergence	57 mrad
Number of lasers	9 (Lux 9 model), 12 (Professional 12 model)
This Laser Product is designated as Class 3R during all procedures of operation.	
Note:	HairMax LaserComb has no user-serviceable parts.
Location:	On the underside of the handle Model version varies

Power Supply Specifications

Output = 6VDC 1.0A. Plug: 9mm x 3.5mm, center positive.

The power supply for the HairMax LaserComb can be used in the United States and Internationally. This power supply will adapt to all power supplies from 110 volt/60 cycle (US) to 240 volt/50 cycle. If outlets in your country have different plugs than the power supply that comes with the HairMax LaserComb, use an inexpensive plug adapter not supplied with the device.



Cleaning your HairMax LaserComb

- Keep your LaserComb clean.
- Turn off the LaserComb by sliding the power button to the lowest position (Advanced 7) or by pressing and holding the power button (lower button) until green light turns off (Lux 9 and Professional 12).
- Unplug the power cord from the device and from the electrical wall outlet.
- Clean the laser window with a soft, slightly moistened cloth.
- To clean the comb teeth, gently remove any hairs or dust with a slightly moistened towel.
- Don't use any acetone, soap or detergents, only warm water.
- To clean the teeth more thoroughly, gently pull out the comb teeth from the center. Then you can separately wash them using soap and warm water.

- To clean the teeth more thoroughly, slide the teeth towards the top of the LaserComb and gently pull out. Clean with soap and water. To

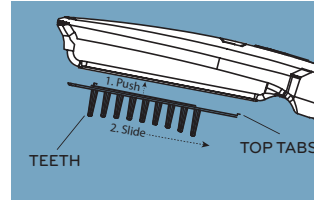

replace the teeth, align the guides and slide down until they lock into place. If you need to replace the teeth, you can order online at

hairmax.com or call Customer Service toll-free at 1-866-527-3726.

Electrical Safety

Basic safety precautions should be observed when using this, or any other electrical device, especially when children are present.

- ⚠ **WARNING:** Keep away from water. Contact with water may result in an electrical shock.

Electrical Safety - continued

To reduce the risk of hazard by electric shock:

- Always unplug the LaserComb from the power outlet immediately after using.
- Do not use while bathing.
- Do not place or store the LaserComb where it can fall or be pulled into a tub or sink. Do not expose the LaserComb to running water, or drop into water or any other liquid. If the LaserComb falls into water, unplug it immediately from the power outlet.
- If using the LaserComb near water, the use of an electrical outlet protected by a Ground Fault Circuit Interrupter is recommended.
- Do not dispose of the LaserComb in a fire or store in high temperatures greater than 140°F (60°C).

Disposal Instructions



This symbol on the product or on its packaging indicates that this product must not be disposed of with your other household waste. Instead, it is your responsibility to dispose of your waste equipment by handing it over to a designated collection point for the recycling of waste electrical and electronic equipment. The separate collection and recycling of your waste equipment at the time of disposal will help to conserve natural resources and ensure that it is recycled in a manner that protects human health and the environment. For more information about where you can drop off your waste equipment for recycling, please contact your local city office or your household waste disposal service.

WARRANTY

ANY ATTEMPT TO SELF-SERVICE YOUR DEVICE, UNLESS INSTRUCTED BY HAIRMAX CUSTOMER SERVICE, WILL VOID YOUR WARRANTY.

THE HAIRMAX LASERCOMB IS WARRANTED BY LEXINGTON INTERNATIONAL LLC ("MANUFACTURER") AGAINST DEFECTS IN MATERIALS OR WORKMANSHIP FOR 24 MONTHS FROM DATE OF PURCHASE. IF THIS PRODUCT IS DETERMINED TO BE DEFECTIVE, LEXINGTON WILL REPAIR OR REPLACE IT, AT ITS OPTION, AT NO CHARGE DURING THE WARRANTY PERIOD.

AFTER THE WARRANTY PERIOD, THE USER MUST PAY FOR ALL PARTS AND LABOR CHARGES. IF THE PRODUCT IS REPAIRED OR REPLACED, EITHER WITHIN OR OUTSIDE THE WARRANTY PERIOD, LEXINGTON RESERVES THE RIGHT TO PROVIDE EQUIVALENT PARTS IN DIFFERENT COLORS TO YOUR ORIGINAL PRODUCT.

THIS WARRANTY DOES NOT COVER DAMAGES CAUSED BY ACTS OF GOD, MISUSE, NEGLIGENCE, ACCIDENT, MODIFICATION OF, OR TO ANY PART OF THE PRODUCT. THIS WARRANTY DOES NOT COVER DAMAGE DUE TO IMPROPER OPERATION OR MAINTENANCE, CONNECTION TO IMPROPER VOLTAGE SUPPLY, OR ATTEMPTED REPAIR BY ANYONE OTHER THAN LEXINGTON. THIS WARRANTY IS VOID IF PRODUCT IS TAMPERED WITH.

TO OBTAIN WARRANTY SERVICE, YOU MUST DELIVER THE PRODUCT FREIGHT PREPAID, IN EITHER ITS ORIGINAL PACKAGING OR PACKAGING AFFORDING AN EQUAL DEGREE OF PROTECTION, TOGETHER WITH YOUR NAME AND ADDRESS, TO:

Lexington International LLC , 777 Yamato Road, Suite 105, Boca Raton, FL 33431, USA

LIMITATION OF LIABILITY; INDEMNITY: EXCEPT AS EXPRESSLY SET FORTH ABOVE, LEXINGTON INTERNATIONAL LLC SHALL NOT BE LIABLE FOR ANY SPECIAL, INDIRECT, OR CONSEQUENTIAL DAMAGES THAT ARE DIRECTLY OR INDIRECTLY RELATED TO THE USE OF, OR THE INABILITY TO USE, THE HAIRMAX LASERCOMB , EVEN IF LEXINGTON INTERNATIONAL LLC HAS BEEN ADVISED OF THE POSSIBILITY OF SUCH DAMAGES WHETHER IN AN ACTION OF CONTRACT, NEGLIGENCE OR OTHER TORTUOUS ACTION. SOME STATES DO NOT ALLOW THE EXCLUSION OR LIMITATION OF INCIDENTAL OR CONSEQUENTIAL DAMAGES, SO THE ABOVE LIMITATION OR EXCLUSION MAY NOT APPLY TO YOU.

GOVERNING LAW: THE USAGE OF THE HAIRMAX LASERCOMB AND THE INTERPRETATION OF ITS TERMS SHALL BE GOVERNED BY AND CONSTRUED IN ACCORDANCE WITH THE LAWS OF THE STATE OF FLORIDA APPLICABLE TO AGREEMENTS NEGOTIATED, EXECUTED AND PERFORMED WHOLLY AND SOLELY WITHIN THE STATE OF FLORIDA. THE PARTIES AGREE THAT THE STATE OF FLORIDA'S CONFLICTS OF LAWS RULES SHALL NOT APPLY TO THIS AGREEMENT OR ANY TRANSACTION PERFORMED BY OR UNDER THIS AGREEMENT.

JURISDICTION AND VENUE: THE PARTIES IRREVOCABLY SUBMIT AND CONSENT TO THE SOLE AND EXCLUSIVE JURISDICTION AND VENUE OF THE FLORIDA STATE COURTS IN AND FOR PALM BEACH COUNTY, FLORIDA, U.S.A. AND THE FEDERAL COURTS IN AND FOR THE SOUTHERN DISTRICT OF FLORIDA, U.S.A. THE PARTIES AGREE NOT TO RAISE THE DEFENSE OF FORUM NON CONVENIENS.

AUTHORIZED REPRESENTATIVE IN EUROPE (REGULATORY AFFAIRS ONLY): EMERGO EUROPE, MOLENSTRAAT 15, 2513 BH THE HAGUE, THE NETHERLANDS. TEL: (31) (0) 70 345-8570 FAX: (31) (0) 70-345-7299

To validate your warranty please register online at www.hairmax.com/warranty.

WARRANTY CARD

The HairMax LaserComb has a 2 year warranty against defects in materials or workmanship from Lexington International, LLC. Items that are damaged or abused are not covered under the warranty and will be charged at their regular repair rates. **ANY ATTEMPT TO SELF-SERVICE YOUR DEVICE, UNLESS INSTRUCTED BY HAIRMAX CUSTOMER SERVICE, WILL VOID YOUR WARRANTY.** Please refer to the User Manual for complete warranty terms. We guarantee your satisfaction.

To validate your warranty card register online at www.hairmax.com/warranty

or complete and mail this warranty card

Name:

Serial Number:

Date of Purchase:

located on yellow safety label,
on the bottom of the device

Address:

City: State: ZIP/Postal Code:

Country: Email:

Where did you purchase this product (Reseller Name)?

What factors influenced your purchase of this product?

*Please fill out this form, detach it, place it in the envelope or fold out and mail it directly back to us with a postage stamp.



Staple or
tape here

Return address:

Place
stamp
here

Lexington International, LLC
2901 Clint Moore Road #260
Boca Raton, FL 33496



HAIRMAX[®]

The science of hair growth.

HairMax Customer Service:

Phone: 1-866-527-3726
+1-561-417-0200

Email: info@hairmax.com
HAIRMAX.com

Mailing Address:

Lexington International
777 Yamato Rd., Ste 105
Boca Raton, FL 33431
USA

To view videos about usage, quality and safety, visit:

www.hairmax.com/videos
www.hairmax.com/QualitySafety

© Copyright 2014 Lexington Intl, LLC. All rights reserved.



HAIRMAX.COM

For International Translations visit www.hairmax.com/manual



HAIRMAX.COM | 1-866-LASERCOMB (1-866-527-3726)